

LogHome67



Tel: 0131 552 4928 info@loghomescotland.co.uk

From £ 44,000 / Ex Delivery. Modular House / Kit Materials:

1. Floor construction in panels from impregnated pressure treated timber 45X 195mm at 400 centres. Gluelam joists 90X195mm for load bearing partition stud walls. Insulation 200mm. Scandinavian 28mm T&G pine flooring. Listing /// skirting boards. DPC belt. Under frame 8 or 12mm OSB.
2. Tilt & turn treble glazed timber windows with Argon filled gas. (Already installed in Walls). Double glazed timber doors. Reinforced // Toughened glass. Security locks. Handles. Ventilation slots. Frames. Timber finishing. Architraves inside & out.
3. Wall construction 280mm+ thick, externally clad with 22mm timber Weather Boarding 145X 95mm timber stud frame. Battens. 12mm OSB. Insulation 200mm. Vapour barrier. 13mm plasterboards inside and T&G timber cladding to suite.
4. Internal walls from stud frame overall 126mm thick. Rocksil wool slab 100mm for sound insulation. 13mm plasterboards both sides & timber clad to suite.
5. Roof construction in panels from 45X 195mm C16 timber rafters at 600mm centers. Insulation 250mm. 15mm OSB or 18mm Sarking. Roof tiles Battens. 11X 88mm pine cladding. Vapour barrier. 18X 120mm eaves & gable boards.
6. Extensive list of building accessories: Fixings, metal straps, nails, screws, tape, building foam, bird / insect net, flashings, building paper, wind barrier, Silicone guns, preservatives, Remmers waterproof paints & much more. List on request. .
7. Architect working drawings includes: foundations plan, floor plan, elevations, detailed drawings of all construction components & installation instructions. Free bespoke design.

Optional extras:

Log Home Scotland to assemble modular house. Or, our master craftsman (1) to assist you / your builder on site, ensuring speedy correct installation. Interior finishing, kitchen, bathroom, clean burning multi-fuel stoves. Solar/ wind power.

© 2017 Log Home Scotland



Roof: U Value 0,15. Walls: U 0,21. Now available in 1,5 storey.
Painted exterior Remmers waterproof

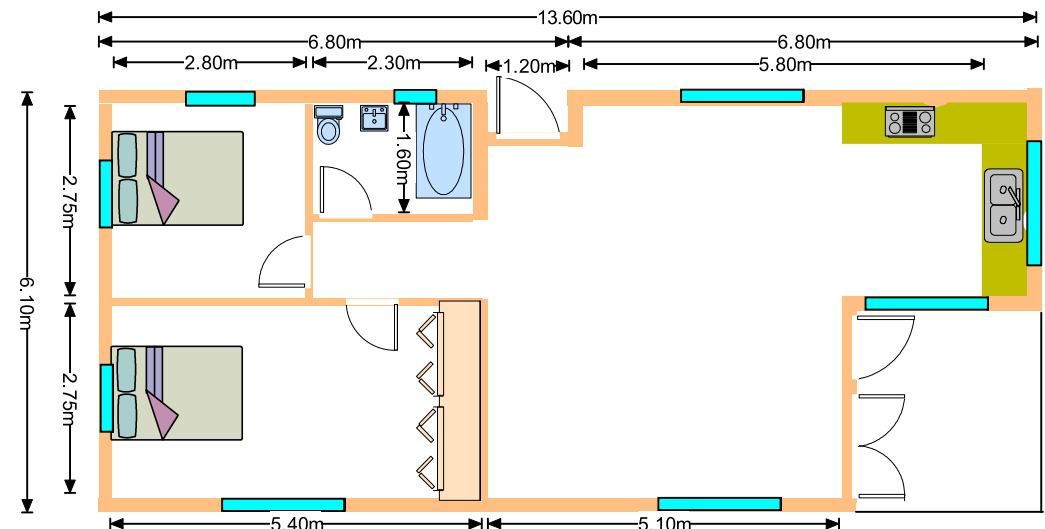

Total Area: 82.96m²

Floor Area: 67.07m²

Terrace: 7.10m²