

### FIRST FLOOR (PANEL)

- OSB (22mm) OR T&G (28mm)  
SCANDINAVIAN PINE  
FLOOR BOARDS
- CEILING BEAM (220mm)  
INSULATION (200mm)
- VAPOUR BARRIER
- VENTILATION SLAT (22mm)
- PLASTERBOARD (13mm)OR  
TIMBER CLAD CEILING  
BOARD, T&G PINE (12mm / 18mm)

### INTERNAL WALL

- PLASTERBOARD (13mm) AND OR  
TIMBER CLAD T&G (12mm / 18mm)
- OSB (12mm)
- TIMBER FRAME (145mm / 95mm)
- SOUND INSULATION ( 150mm / 100mm)
- OSB (12mm) >> RAKING
- PLASTERBOARD (13mm) AND OR  
TIMBER CLAD T&G (12mm / 18mm)

### ROOF

- ROOF COVERING (Type TBA)
- VENTILATION CAVITY  
CROSS BATTENS (2X 25mm)
- ROOFING UNDERLAY
- OSB 18mm OR SARKING (18mm)
- VENTILATION BATTENS 45X50mm
- WIND BARRIER
- RAFTERS 195mm  
INSULATION 200mm  
(300mm insulation on request)
- VAPOUR BARRIER
- EXTRA INSULATION BATTENS (50mm)  
+ EXTRA INSULATION (50mm)
- ROOF CEILING BATTENS 30X50mm
- PLASTERBOARD (13mm)  
OR TIMBER CLAD T&G PINE (18mm)

**U VALUE**  
INSULATION 200  
**U=0,11**  
INSULATION 50

## TIMBER FRAME CROSS SECTION

Material components for pre fabricated modular house with optional wall / / insulation thickness

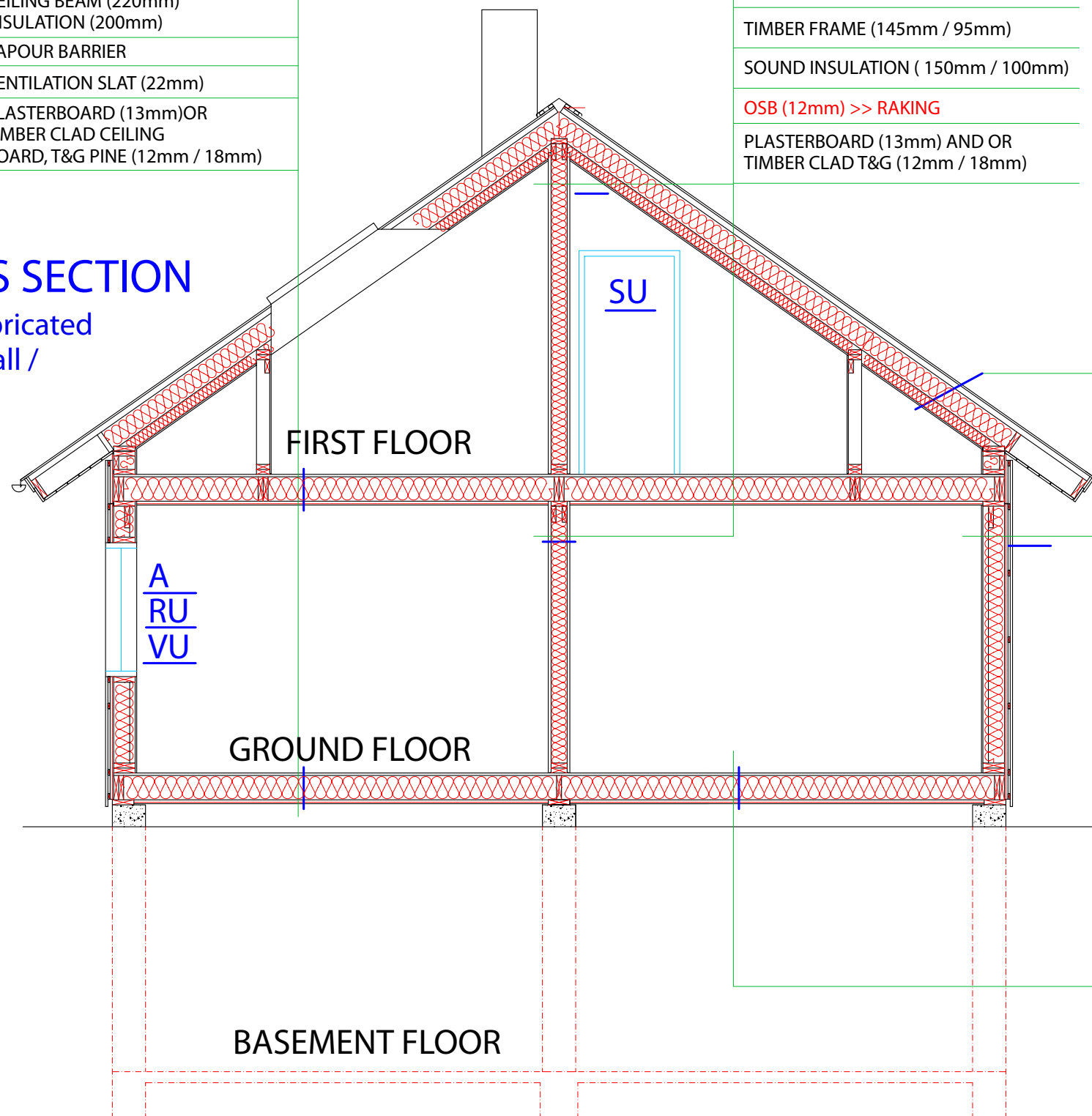

### EXTERNAL WALLS

- PINE / TIMBER CLAD (21mm)  
Horizontal, Vertical, Hit-N-Miss,  
Shiplap or any combination
- VENTILATION CAVITY (50mm)  
BATTENS (2X25mmX50mm)
- BREATHER MEMBRANE  
WEATHER BOARD - OSB (12mm)
- TIMBER FRAME STUDS  
(220mm/ 195mm / 145mm / 95mm)  
INSULATION  
( 220mm/ 200mm / 150mm / 100mm)
- VAPOUR BARRIER
- EXTRA INSULATION BATTENS (50mm)  
EXTRA INSULATION (50mm)
- PLASTERBOARD (13mm) AND / OR  
TIMBER CLAD (12mm / 18mm)

**U VALUE**  
INSULATION 220  
**U=0,16**  
INSULATION 50

### FLOOR

- T&G SCANDINAVIAN PINE  
FLOOR BOARDS (28mm)
- FLOOR JOISTS (220mm)  
INSULATION (220mm)
- OSB (8mm / 12mm)
- IMPREGNATED SUB FRAME \*  
(195mm / 145mm / 95mm)

**WINDOWS - A**  
**BALCONY DOORS - RU**  
**ENTRANCE DOORS - VU**  
**INTERNAL DOORS - SU**

\* Not featuring but is included subject to foundation's type