

FIRST FLOOR (PANEL)

- OSB (22mm) OR T&G
SCANDINAVIAN PINE
FLOOR BOARDS (28mm)
- CEILING BEAM (220mm)
INSULATION (200mm)
- VAPOUR BARRIER
- VENTILATION SLAT (22mm)
- PLASTERBOARD (13mm)
OR TIMBER CLAD CEILING
BOARD, T&G PINE (18mm)

INTERNAL WALL

- PLASTERBOARD (13mm)
AND / OR TIMBER CLAD T&G (18mm / 21mm)
- OSB (12mm)
- TIMBER FRAME (195mm / 145mm / 95mm)
- INSULATION (200mm / 150mm / 100mm)
- OSB (12mm)
- PLASTERBOARD (13mm)
AND / OR TIMBER CLAD T&G (18mm / 21mm)

ROOF

- ROOF COVERING (Type of material TBA)
- SARKING (Subject to above)
- VENTILATION BATTENS (22mm)
- ROOFING UNDERLAY
- OSB (15mm / 12mm)
- VENTILATION BATTENS (50mm)
- WIND BARRIER
- RAFTER (195mm)
ROCKWOOL INSULATION (200mm)
- VAPOUR BARRIER
- EXTRA INSULATION BATTENS (50mm)
+ EXTRA INSULATION (50mm)
- PLASTERBOARD (13mm)
AND / OR TIMBER CLAD, T&G PINE (18mm)

U VALUE
INSULATION 200
INSULATION 50
U=0,16

TIMBER FRAME CROSS SECTION

Material components for pre fabricated modular house with optional wall / / insulation thickness

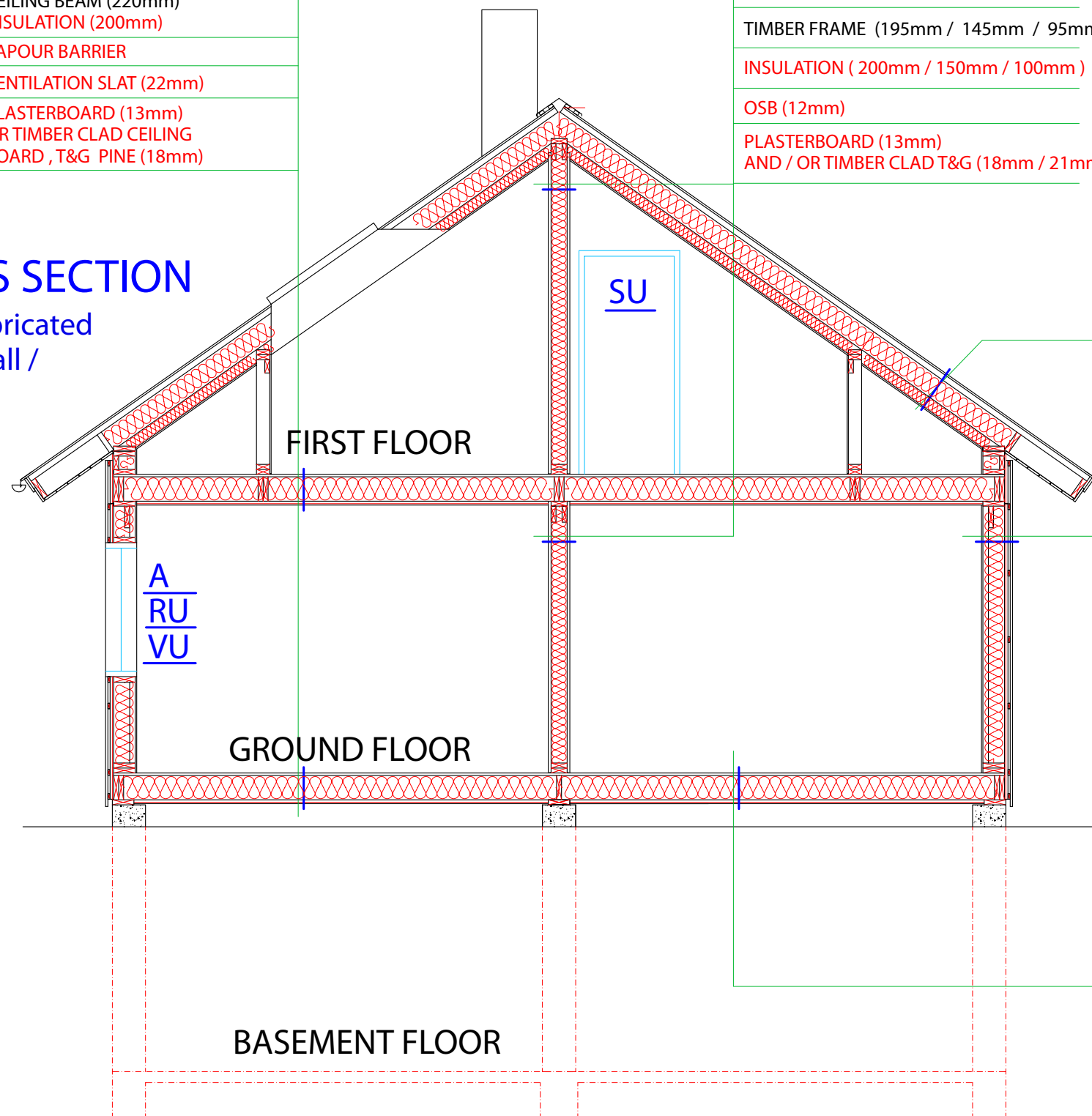

EXTERNAL WALL

- PINE / TIMBER CLAD (21mm)
Horizontal, Vertical Or Both
- VENTILATION BATTENS (22mm)
- WIND BARRIER (AT CORNERS)
WEATHER BOARD - OSB
(12mm)
- TIMBER FRAME
(195mm / 145mm / 95mm)
- ROCKWOOL INSULATION
(200mm / 150mm / 100mm)
- VAPOUR BARRIER
- EXTRA INSULATION BATTENS (50mm)
EXTRA INSULATION (50mm)
- PLASTERBOARD (13mm)
AND / OR TIMBER CLAD (18mm / 21mm)

U VALUE
INSULATION 150
INSULATION 50
U=0,23

FLOOR

- T&G SCANDINAVIAN PINE
FLOOR BOARDS (28mm)
- ROCKWOOL INSULATION (200mm)
- FLOOR JOISTS (220mm)
- OSB (8mm / 12mm)
- IMPREGNATED SUB FRAME *
(195mm / 145mm / 95mm)

WINDOWS - A
BALCONY DOORS - RU
ENTRANCE DOORS - VU
INTERNAL DOORS - SU

* Not featuring but is included subject to foundation's type